

Inspection glass type 28



| Material | PVC-U | PP | PVDF |
|-------------------------------|---|--------------------------------|------------------------------------|
| Sealing material (optionally) | • EPDM | | • FKM |
| Working temperature | 0 °C up to 60 °C ¹⁾ | 0 °C up to 80 °C ¹⁾ | - 20 °C up to 100 °C ¹⁾ |
| Nominal size | DN 15 up to DN 150 | | |
| Connection with pipe | Flange connection acc. to DIN EN 1092-1 - PN 10 ²⁾ | | |
| Length | Company standard | | |

²⁾ Flange connection also acc. to ANSI available

¹⁾ Working temperatures for sealing materials:

EPDM: -20 up to 90 °C

FKM: -20 up to 120 °C

Example for an invitation to tender text:

Inspection glass type 28, DN 25, PP / EPDM, PN 10, flange connection acc. to DIN EN 1092-1 - PN 10, length 160 mm

Inspection glass type 28

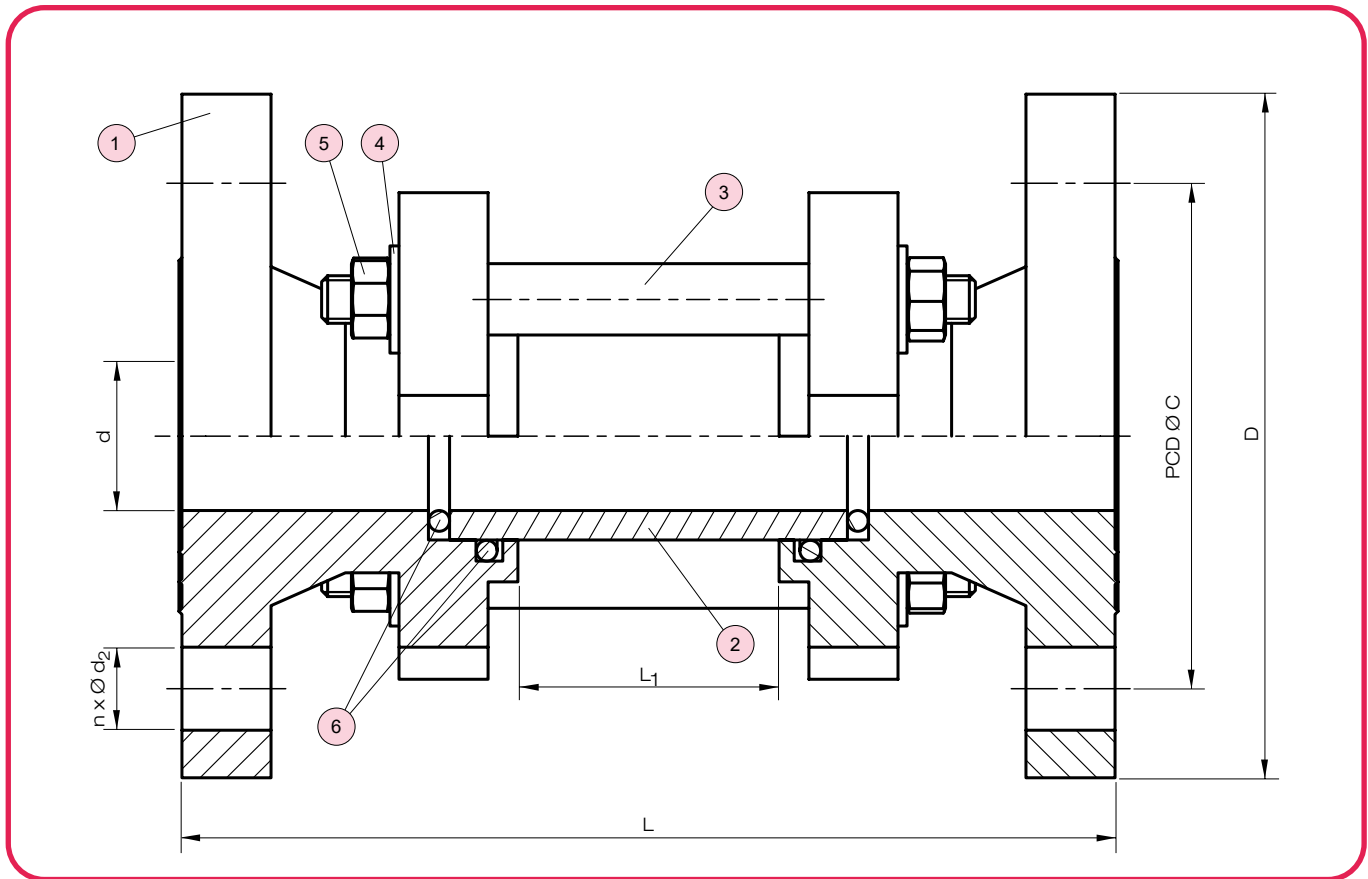

| No. | Description | Number | Material |
|-----|----------------------|--------|-----------------------|
| 1 | Flange | 1 | PVC, PP, PVDF |
| 2 | Pipe | 1 | Borosilicate |
| 3 | Threaded rod | 4 | A2 - 1.4301 (SUS 304) |
| 4 | Washer | 8 | A2 - 1.4301 (SUS 304) |
| 5 | Nut | 8 | A2 - 1.4301 (SUS 304) |
| 6 | O-ring ^{*)} | 4 | EPDM, FKM |

^{*)} Wearing parts

Inspection glass type 28

Dimensions and weights - flange connection acc. to DIN

| Dimensions in mm | | | | | | | Weight in kg / pc. | | |
|------------------|-----|-----|-----|----------------|-----|--------------------|--------------------|-------|-------|
| DN | d | L | D | L ₁ | C | n x d ₂ | PVC | PP | PVDF |
| 15 | 20 | 140 | 95 | 26 | 65 | 4 x 14 | 0,80 | 0,50 | 1,00 |
| 20 | 25 | 150 | 105 | 36 | 75 | 4 x 14 | 1,30 | 0,80 | 1,60 |
| 25 | 32 | 160 | 115 | 46 | 85 | 4 x 14 | 1,30 | 1,00 | 1,50 |
| 32 | 40 | 180 | 140 | 58 | 100 | 4 x 18 | 1,60 | 1,20 | 1,80 |
| 40 | 50 | 200 | 150 | 70 | 110 | 4 x 18 | 2,10 | 1,60 | 2,40 |
| 50 | 63 | 230 | 165 | 92 | 125 | 4 x 18 | 2,60 | 1,90 | 2,90 |
| 65 | 75 | 290 | 185 | 116 | 145 | 4 x 18 | 3,80 | 3,00 | 4,50 |
| 80 | 90 | 310 | 200 | 126 | 160 | 8 x 18 | 5,60 | 4,20 | 6,30 |
| 100 | 110 | 350 | 220 | 166 | 180 | 8 x 18 | 6,40 | 4,60 | 7,00 |
| 125 | 110 | 400 | 250 | 196 | 210 | 8 x 18 | 13,30 | 8,50 | 16,60 |
| 150 | 160 | 480 | 285 | 240 | 240 | 8 x 22 | 13,80 | 10,80 | 16,00 |

Working pressure¹⁾ p_B in bar

| Body material | T _B [°C] | p _B [bar] | | |
|---------------|---------------------|----------------------|------------|--------------|
| | | DN 25 - 50 | DN 65 - 80 | DN 100 - 150 |
| PVC-U | 0 up to 20 | 10 | 7 | 6 |
| | 40 | 6 | 6 | 6 |
| | 60 | 3 | 3 | 3 |
| PP | 0 up to 30 | 10 | 7 | 6 |
| | 50 | 7 | 7 | 6 |
| | 80 | 3 | 3 | 3 |
| PVDF | - 20 up to 65 | 10 | 7 | 6 |
| | 80 | 7,5 | 7 | 6 |
| | 100 | 4,5 | 4,5 | 4,5 |

¹⁾ Definition see chapter T2 / Technical information

Inspection glass type 28

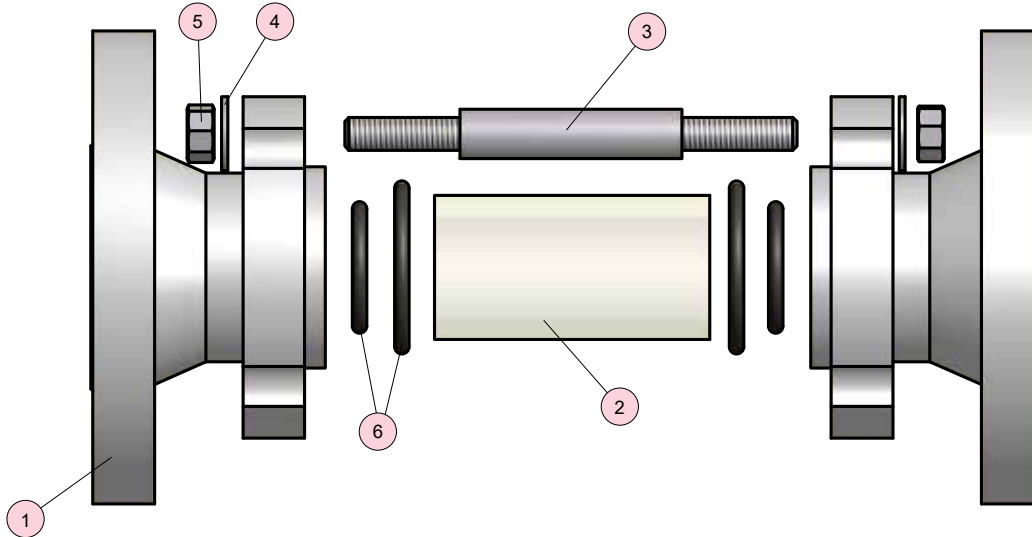

all sizes

General information: *Inspection glasses made of PVC, PP and PVDF are used for visual inspection of fillings and flows in pipelines. The inspection glasses enable reliable monitoring of the function and performance of individual apparatus as well as total systems.*

- Barrier-free passage.
- Double process reliability due to two O-rings.

Disassembly of the valve

Attention: *Never dismantle the valve when the pipe is under pressure.*

During disassembly, it must be ensured that all the components can be reinstalled in their original locations.

Assembly of the valve

- Before the assembly all parts have to be checked for damages.
- All parts have to be clean.

Before installation

- Flush the pipe, check all the screws on the valve, and retighten carefully, if necessary.

Notes for correct installation

- The valve must be installed stress-free in the pipe (plane parallelism, axial, overall length).
- Tighten the connecting screws evenly and crosswise (observe tightening torques). In general, use washers for the nuts and bolts in plastic flanges.
- The use of fullface gaskets is recommended.
- After assembly carry out a pressure test acc. to DIN EN 12266-1.

Important:

- After commissioning, all the screws on the valve must be checked, and retightened if necessary.